

**MOTOR DIMENSIONS**  
NEMA C56 FRAME 1750 RPM

HP	FRAME	ODP			TEFC		
		L	O	AB	L	O	AB
.50	C56	8.37	6.5	3.25	9.43	7.04	5.31
.75	C56	8.37	6.5	3.25	9.43	7.04	5.31

See JM frame for .75 – 1.5 HP

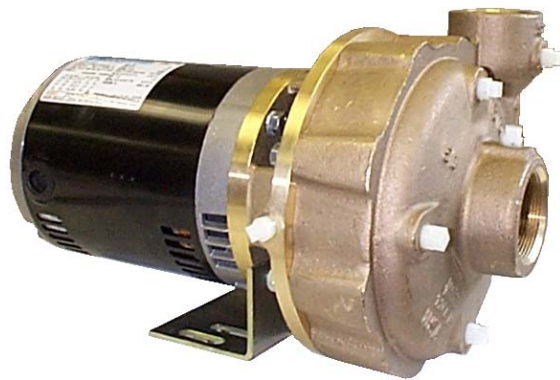
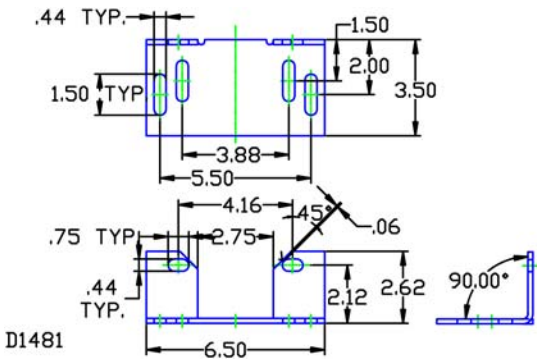

D1481 05007DP  
D052BC56 0521450  
**52B**  
C56  
052B1750C56  
81.001.730 H14

D052BC56

DRAWING DEPICTS 56C ODP MOTOR

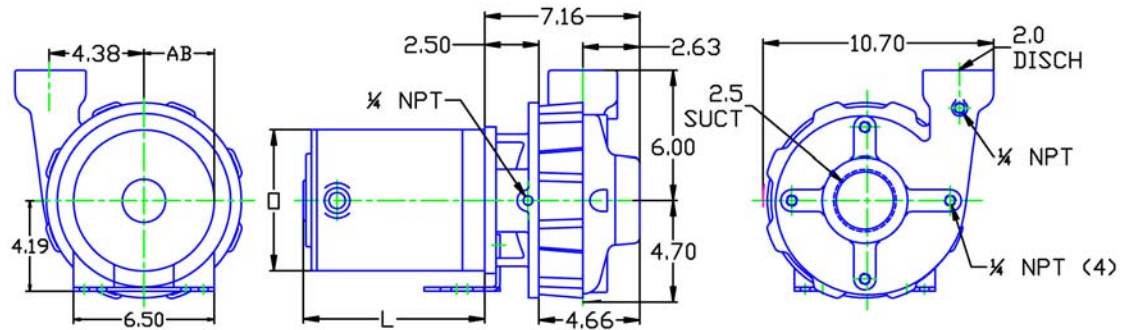

**ALL DIMENSIONS IN INCHES.**

DRAWING REPRESENTS APPROXIMATE PUMP DIMENSIONS. AUTOCAD DRAWINGS TO SCALE AVAILABLE FROM FACTORY.

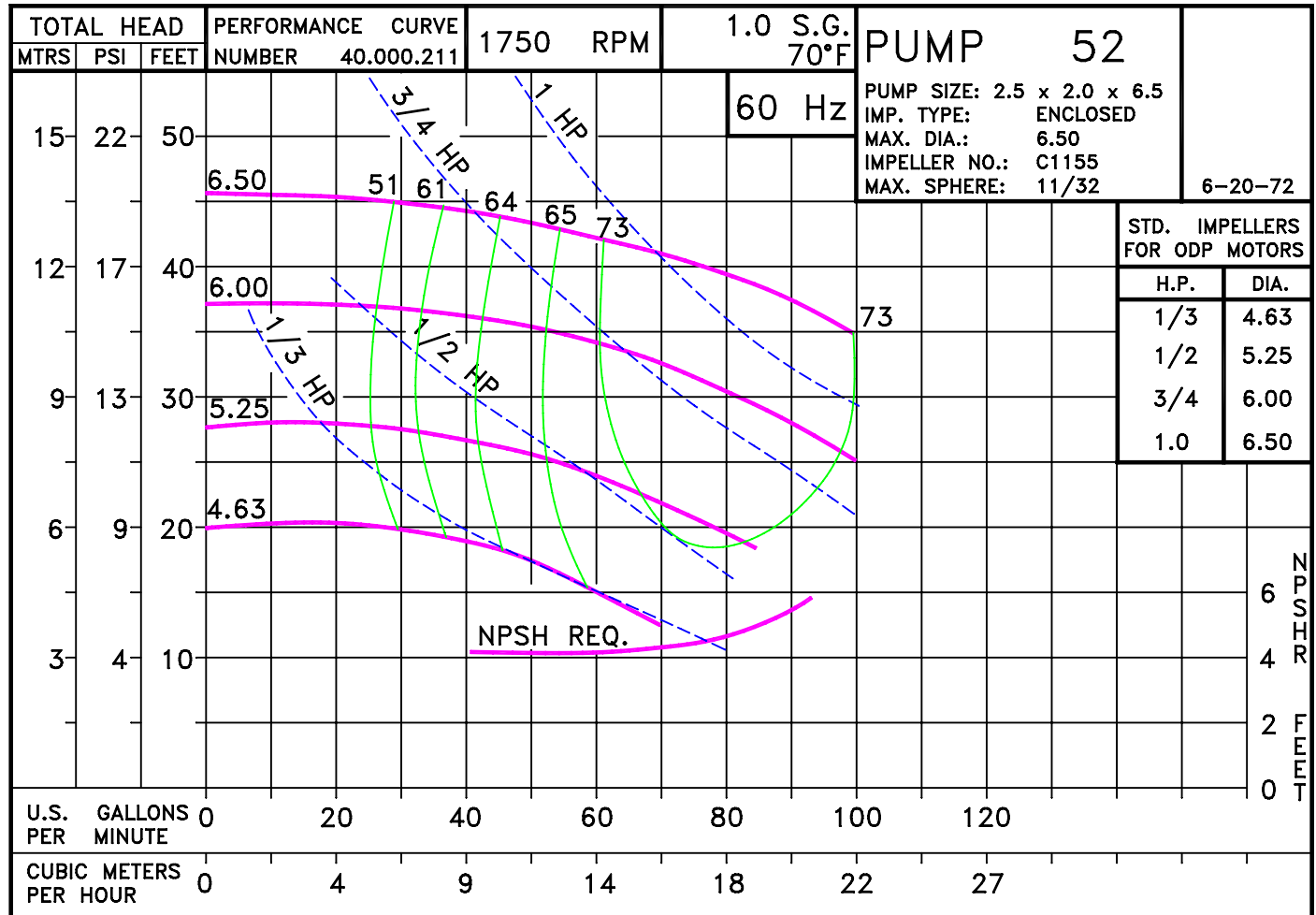

# Pump 52B • Bronze • C56 Frame • 1750 RPM

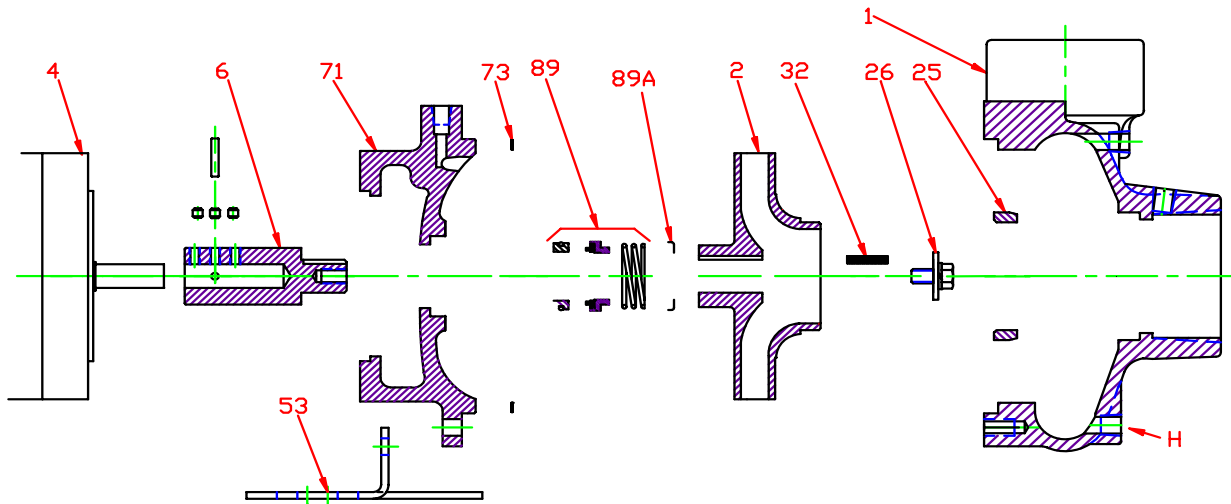

KEY NO.	PART NAME	PUMP NO. 52B
1+	CASE, BRONZE, 2.5 x 2 NPT	130.000.218X
2	IMPELLER, 7/8" KEYED, ENCLOSED, SPECIFY DIAMETER: BRONZE	131.000.810
4	MOTOR, C56	See Chart
6*†	STUB SHAFT, BRONZE STUB SHAFT, STAINLESS	135.000.165X 135.000.174X
25	WEAR RING, BRONZE	103.000.136
26*	IMPELLER RETAINER, STAINLESS	118.000.163A
32*	KEY, STAINLESS	102.000.102
53	BASE, STEEL	119.000.237D
--	ADAPTER, BRONZE	132.000.228X
73*	GASKET, CASE, FIBER	116.000.157
89*	1½" SEALS:	
	BN-CARB/CM	101.000.168
	VN-CARB/CM	101.000.191
	VN-CARB/SIL	101.000.175
	VN-SIL/SIL	101.000.204
	EPDM-CARB/SIL	101.000.175B
89A*	EPDM-SIL/SIL	101.000.204A
89A*	SEAL RETAINER, STAINLESS	104.000.174
--	° REPAIR KITS:	
	BN-CARB/CM SEAL	118.000.382
	VN-CARB/CM SEAL (S)	118.000.382A
	VN-CARB/SIL SEAL	118.000.382B
	VN-SIL/SIL SEAL (S)	118.000.382D
	EPDM-CARB/SIL SEAL	118.000.382C
	EPDM-SIL/SIL SEAL	118.000.382E

\* DENOTES COMPONENTS INCLUDED IN REPAIR KIT.  
 + INCLUDES BRONZE WEAR RING.  
 ° ALL REPAIR KITS INCLUDE THE BRONZE STUB SHAFT EXCEPT THE VN-CM SEAL, WHICH IS STAINLESS.  
 † INCLUDES SET SCREWS AND PIN

**Pump 52B • Bronze • C56 Frame • 1750 RPM**

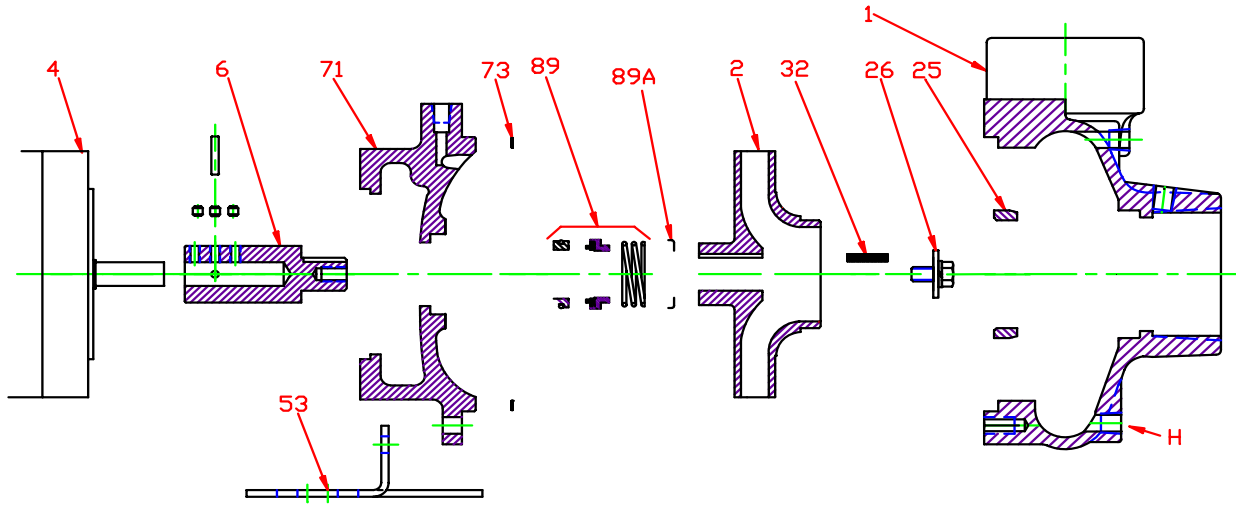

CONSTRUCTION OPTIONS		
KEY	PART NAME	ALL BRONZE
1	Case	Bronze
2	Impeller	Bronze
6	Shaft Stub	Bronze
25	Wear Ring	Bronze
26	Impeller Retaining Assy	Stainless
32	Key	Stainless
53	Base	Steel
71	Adapter	Bronze
73	Gasket, Case	Fibre
89	Mechanical Seal, Type 21 BN-CM	Standard
89A	Seal Spring Retainer	Stainless
H	Plug, Drain	Brass

E054C56

L12

C052B1750C56