

MOTOR DIMENSIONS

NEMA PREMIUM EFFICIENT JM FRAME 3 PHASE 1750 RPM

| HP | Type | Frame | D | E | F | O | AB | BG | L | MH |
|-----|------|-------|------|------|------|------|------|------|------|------|
| 1 | ODP | JM143 | 3.50 | 2.75 | 2.00 | 6.77 | 5.67 | 4.88 | 4.63 | 0.34 |
| 1.5 | ODP | JM145 | 3.50 | 2.75 | 2.50 | 6.77 | 5.61 | 5.38 | 4.63 | 0.34 |
| 1 | TEFC | JM143 | 3.50 | 2.75 | 2.00 | 7.00 | 6.25 | 4.57 | 5.84 | .34 |
| 1.5 | TEFC | JM145 | 3.50 | 2.75 | 2.50 | 7.00 | 6.25 | 4.57 | 5.84 | .34 |

See C56 frame for .50 - .75 HP

D052JM145

DRAWING DEPICTS JM145 1.5HP ODP MOTOR

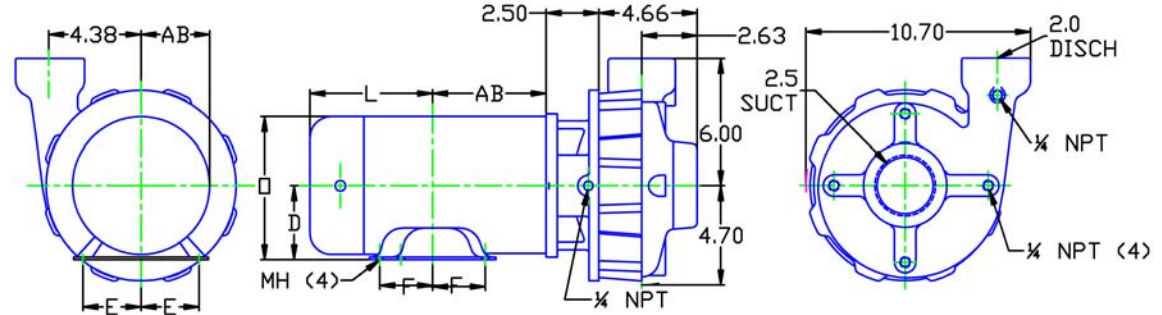

ALL DIMENSIONS IN INCHES.

DRAWING REPRESENTS APPROXIMATE PUMP DIMENSIONS. AUTOCAD DRAWINGS TO SCALE AVAILABLE FROM FACTORY.

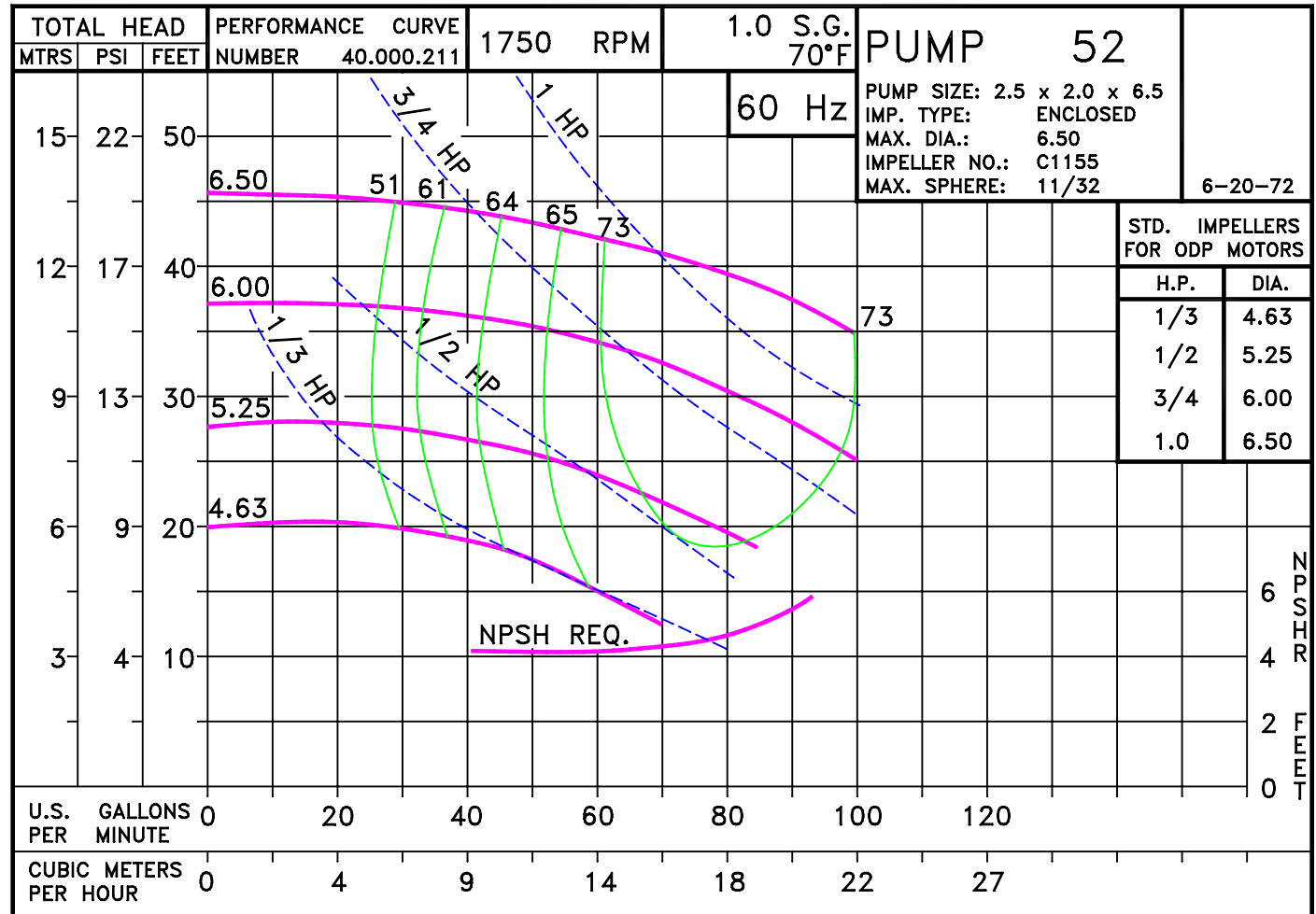

05005DP

D052JM145
0521750

52
JM

0521750JM
81.001.097 H16

Pump 52 • Iron • JM Frame • 1750 RPM

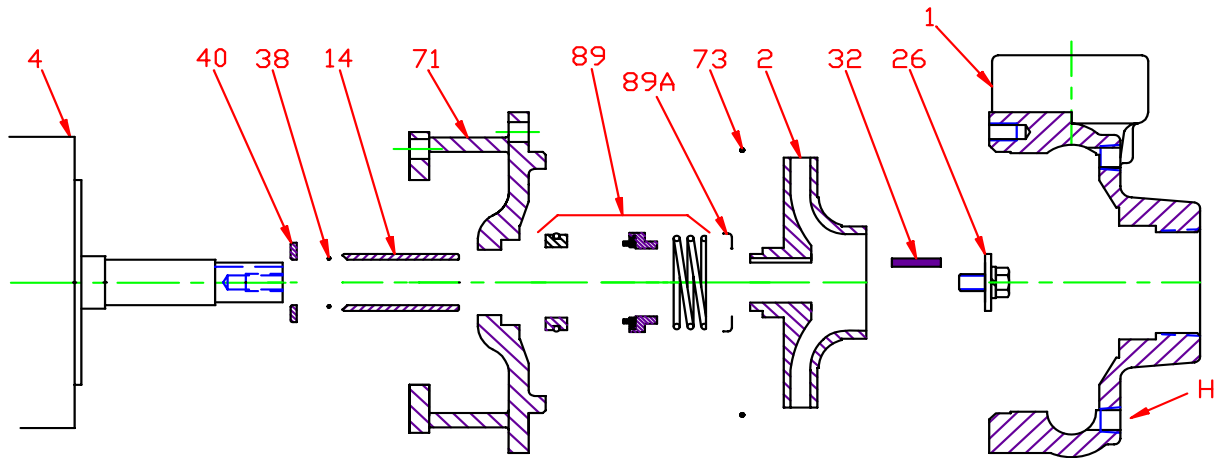

| KEY NO. | PART NAME | PUMP NO. 52 |
|---------|---|---|
| 1+ | CASE, IRON, 2.5 x 2 NPT | 130.000.219X |
| 2 | IMPELLER, 7/8" KEYED, ENCLOSED, SPECIFY DIAMETER: IRON BRONZE | 137.000.120 131.000.810 |
| 4 | MOTOR, JM140/180 | See Chart |
| 14* | SHAFT SLEEVE, BRONZE SHAFT SLEEVE, STAINLESS | 110.000.178 110.000.192 |
| 25 | WEAR RING, BRONZE WEAR RING, STEEL | 103.000.136 103.000.154 |
| 26* | IMPELLER RETAINER, STAINLESS | 118.000.163A |
| 32* | KEY, STAINLESS | 102.000.102 |
| 38* | O-RING, SHAFT, BUNA O-RING, SHAFT, VITON | 116.000.117 116.000.105 |
| 40* | FLINGER, STAINLESS | 104.000.165 |
| 71 | ADAPTER, IRON - JM140/180 | 132.000.202X |
| 73* | GASKET, CASE, FIBER | 116.000.157 |
| 89* | 1½" SEALS: BN-CARB/CM VN-CARB/CM VN-CARB/SIL VN-SIL/SIL EPDM-CARB/SIL EPDM-SIL/SIL | 101.000.168 101.000.191 101.000.175 101.000.204 101.000.175B 101.000.204B |
| 89A* | SEAL RETAINER, STAINLESS | 104.000.174 |
| -- | ° REPAIR KITS: BN-CARB/CM SEAL VN-CARB/CM SEAL (S) VN-CARB/CM SEAL VN-CARB/SIL SEAL VN-SIL/SIL SEAL (S) EPDM-CARB/SIL SEAL EPDM-SIL/SIL SEAL | 118.000.344 118.000.344A 118.000.344K 118.000.344B 118.000.344F 118.000.344C 118.000.344D |

* DENOTES COMPONENTS INCLUDED IN REPAIR KIT.

+ INCLUDES BRONZE WEAR RING. FOR STEEL WEAR RING, REPLACE SUFFIX "X" WITH "X1".

° ALL REPAIR KITS INCLUDE THE BRONZE SHAFT SLEEVE EXCEPT THE (S) INDICATED, WHICH IS STAINLESS WITH VITON SHAFT O-RING.

Pump 52 • Iron • C56 Frame • 1750 RPM

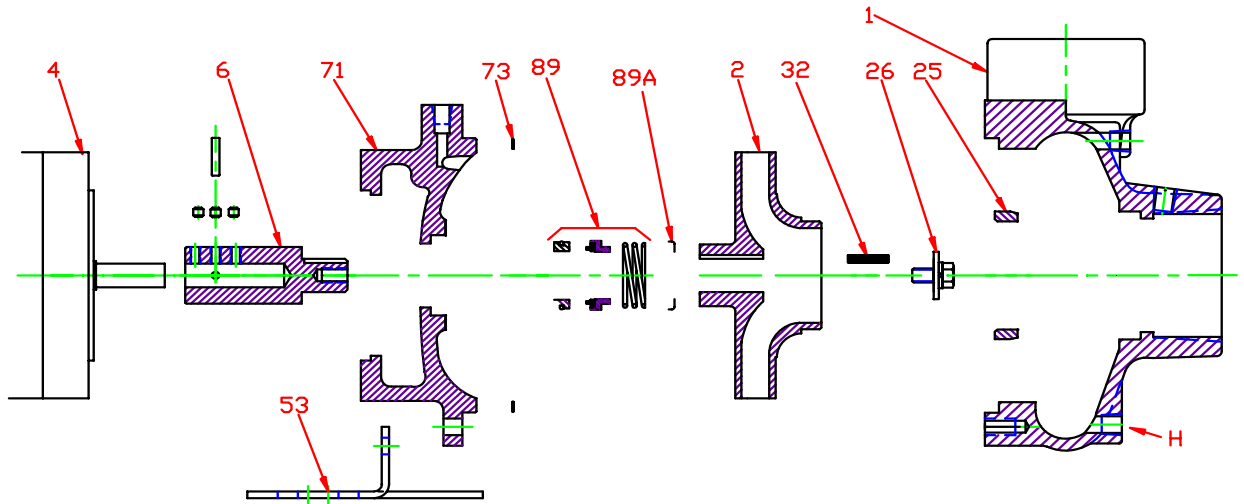

| CONSTRUCTION OPTIONS | | | | |
|----------------------|--------------------------------|-----------------|---------------|--------------|
| KEY | PART NAME | STANDARD FITTED | BRONZE FITTED | ALL IRON |
| 1 | Case | Iron | Iron | Iron |
| 2 | Impeller | Iron | Bronze | Iron |
| 6 | Shaft Stub | Bronze | Bronze | Stainless |
| 25 | Wear Ring | Bronze | Bronze | Steel |
| 26 | Impeller Retaining Assy | Stainless | Stainless | Stainless |
| 32 | Key | Stainless | Stainless | Stainless |
| 53 | Base | Steel | Steel | Steel |
| 71 | Adapter | Iron | Iron | Iron |
| 73 | Gasket, Case | Fiber | Fiber | Fiber |
| 89 | Mechanical Seal, Type 21 BN-CM | Standard | Standard | Standard |
| 89A | Seal Spring Retainer | Stainless | Stainless | Stainless |
| H | Plug, Drain | Brass | Brass | Plated Steel |

E054C56

H12

C0521750C56