

MOTOR DIMENSIONS NEMA J56 FRAME 3500 RPM

HP	FRAME	ODP						TEFC					
		3PH			1PH			3PH			1PH		
		L	O	AB	L	O	AB	L	O	AB	L	O	AB
.75	J56	8.37	6.50	3.25	10.83	8.75	3.25	9.43	7.04	5.31	12.00	8.10	5.31
1.0	J56	8.37	6.50	3.25	11.02	8.75	3.25	9.43	7.04	5.31	13.18	8.10	5.31
1.5	J56	8.87	6.50	3.25	11.33	8.75	3.25	9.43	7.04	5.31	13.18	8.10	5.31
2.0	J56	8.87	6.50	3.25	10.69	8.75	3.25	10.61	7.04	5.31	14.36	8.10	5.31

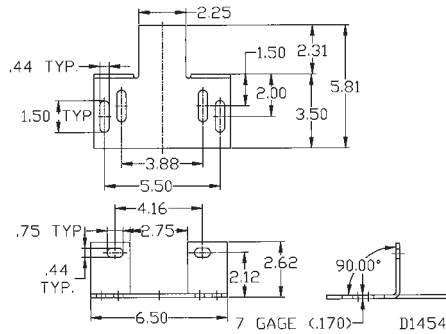
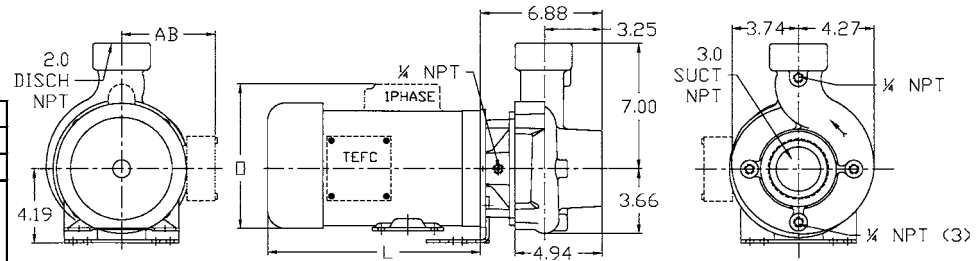

ALL DIMENSIONS IN INCHES.

DRAWING REPRESENTS APPROXIMATE PUMP DIMENSIONS. AUTOCAD DRAWING TO SCALE AVAILABLE FROM FACTORY.

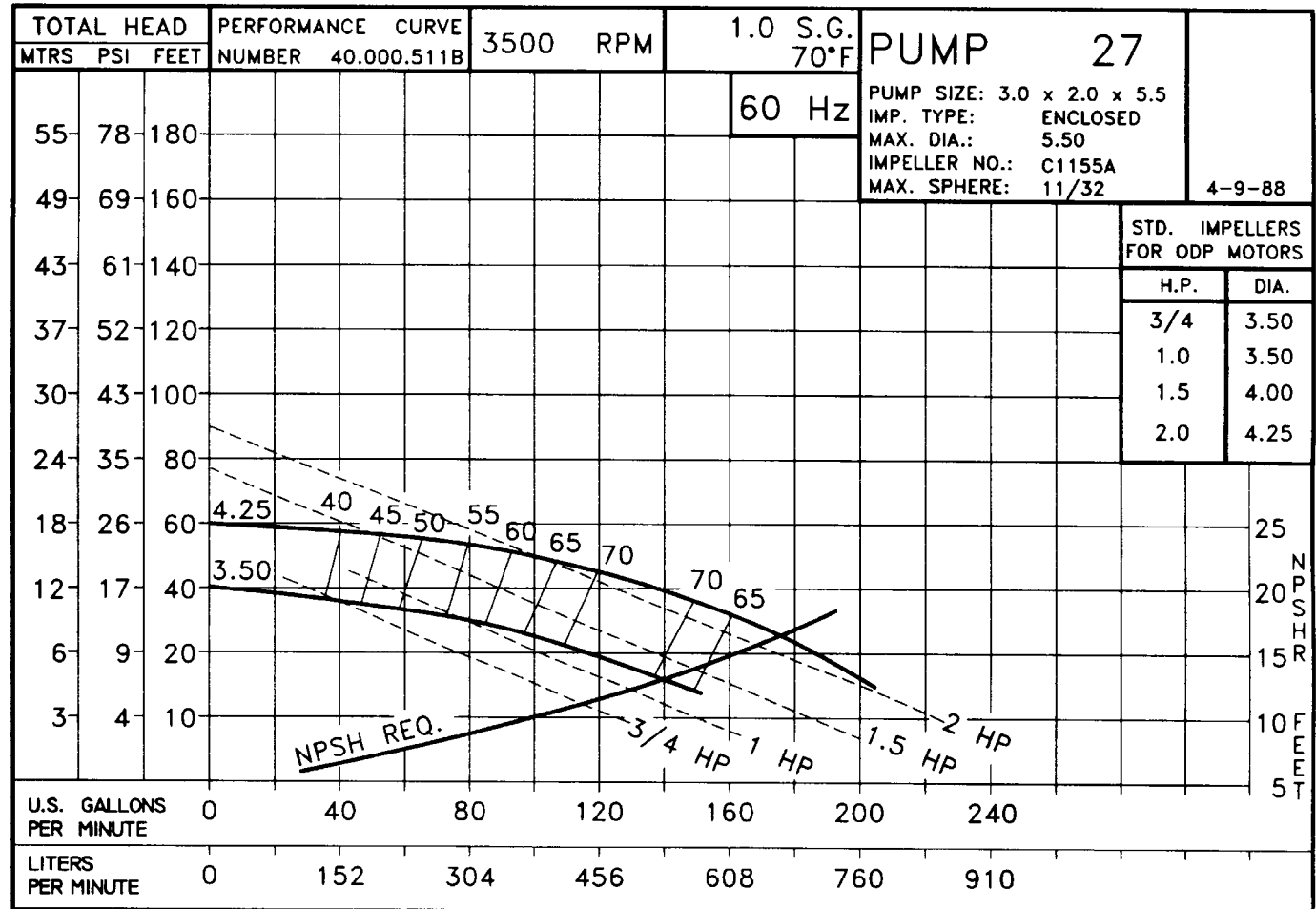

D1454 D027J56
02707DP 027J3500

27 J56

027J3500
81.001.246 D3

Pump 27 • Iron • J56 Frame • 3500 RPM

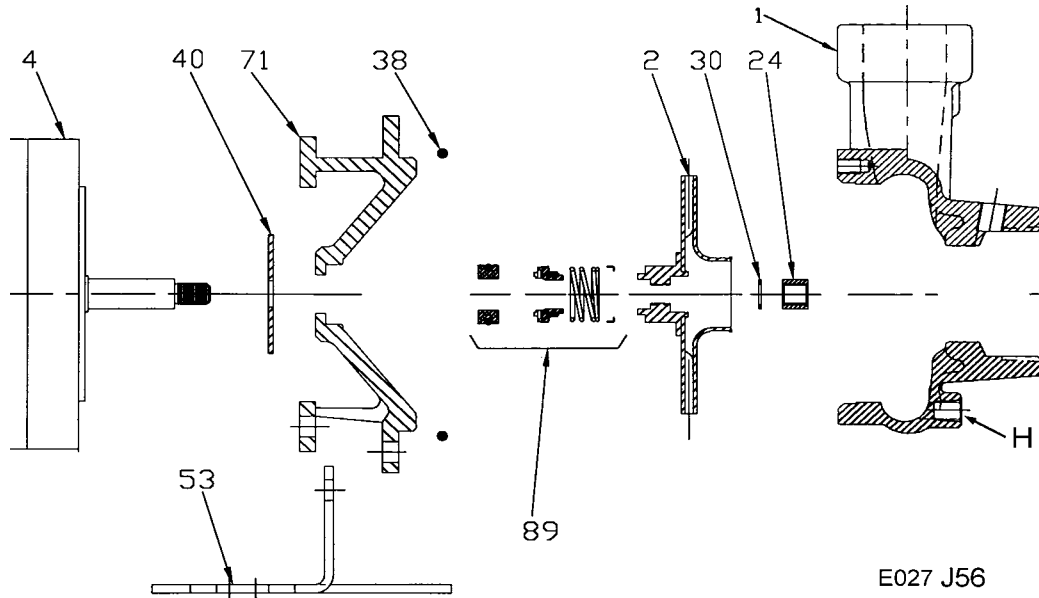

KEY NO.	PART NAME	PUMP 27	
1	CASE, IRON, 3 x 2 NPT	130.000.314X	
2	IMPELLER, 7/16" THREADED, ENCLOSED, SPECIFY DIAMETER:		
	BRONZE	137.000.324	
4	MOTOR:		
	J56, ROUND BODY	See Chart	
	J56, 3.5" RIGID BASE	See Chart	
24*+	NUT, STAINLESS	105.000.465	
30*+	D WASHER, STAINLESS	104.000.168	
40*	FLINGER, NEOPRENE	104.000.171	
53	BASE, STEEL	119.000.231A	
71	ADAPTER, IRON	132.000.337	
73*	GASKET, CASE, BUNA	116.000.146	
	5/8" SEALS:		
	NO RETAINER: (not shown)		
	TYPE 6, BN-CARB/CM	101.000.110	
	WITH RETAINER:		
89*	TYPE 21, VN-CARB/CM	101.000.103	
	TYPE 21, VN-CARB/SIL	101.000.120	
	TYPE 21, VN-SIL/SIL	101.000.239	
	TYPE 21, EPDM-CARB/SIL	101.000.173	
	TYPE 21, EPDM-CARB/CM	101.000.327	
	TYPE 21, EPDM-SIL/SIL	101.000.236	
	REPAIR KITS:	3 PHASE:	† 1 PHASE:
	BN-CARB/CM SEAL	118.000.340	118.000.340.1
	VN-CARB/CM SEAL	118.000.340A	118.000.340A.1
	VN-CARB/SIL SEAL	118.000.340B	118.000.340B.1
	VN-SIL/SIL SEAL	118.000.340J	118.000.340J.1
	EPDM-CARB/SIL SEAL	118.000.340C	118.000.340C.1
	EPDM-CARB/CM SEAL	118.000.340R	118.000.340R.1
	EPDM-SIL/SIL SEAL	118.000.340D	118.000.340D.1

* DENOTES COMPONENTS INCLUDED IN REPAIR KIT.
 + NOT REQUIRED ON 1/3 TO 1-1/2 HP 1 PHASE MOTORS.
 † USE 3 PHASE KIT ON 2-3 HP 1 PHASE MOTORS.

Pump 27 • Iron • J56 Frame • 3500 RPM

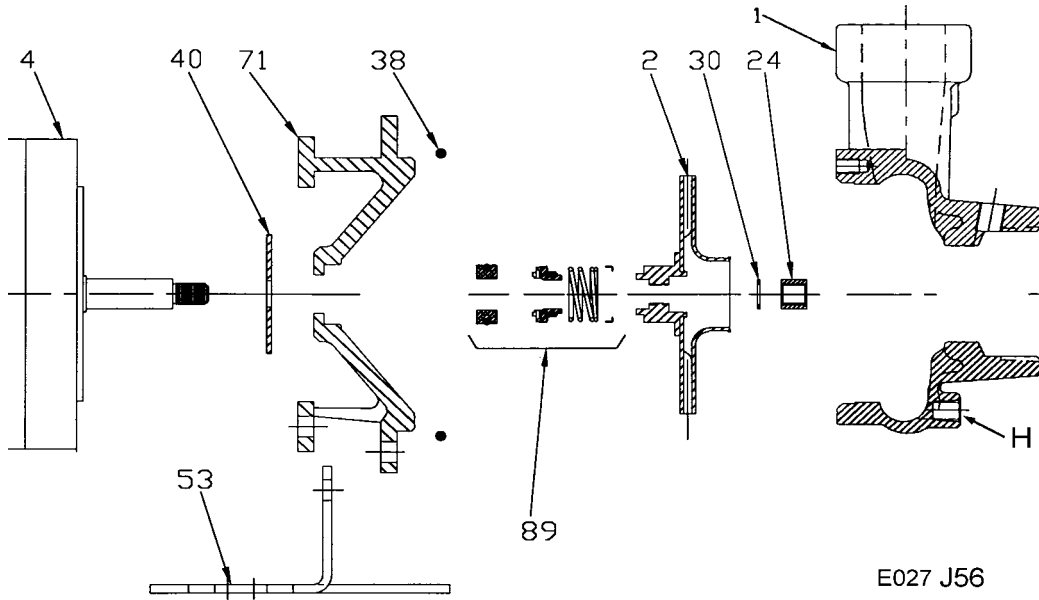

E027 J56

CONSTRUCTION OPTIONS			
KEY	PART NAME	STANDARD FITTED	BRONZE FITTED
1	Case	Iron	Iron
2	Impeller	Bronze	Bronze
24	Impeller Locknut	Stainless	Stainless
30	D-Washer	Stainless	Stainless
40	Flinger	Neoprene	Neoprene
53	Base	Steel	Steel
71	Adapter	Iron	Iron
73	Gasket, Case	Buna	Buna
89	Mechanical Seal, Type 6 BN-CM	Standard	Standard
H	Plug, Drain	Brass	Brass